

***PRO-LITE***

[www.pro-lite.net](http://www.pro-lite.net)

**2 0 0 8**  
**MANUAL**

## ◆ ROAD HANDLEBAR

**RAVENNA - super light carbon bar**

*Building on the work we have done to develop the Cervia aero bar we decided to create the Ravenna super light bar. Only 195 grammes for a 40 cm c-c bar (with integrated cable routing. There was to be no compromise with this bar and as a rider who knows what its like to hit the floor with a broken handlebar, the design team knew full well that Steve (Pro-Lite CEO) would accept nothing less than extreme testing on an item that is vulnerable to extreme loads. Once the initial tests were finished and we knew the bar was more than capable of handling what a rider can throw at it, it was back to the drawing board as Steve then told us to make it stronger. With testing standards exceeded in every way possible and the shape made to ensure that comfort was also of equal importance we now present to you the Ravenna super light carbon bar.*

**1PC monocoque construction**

Series	PL CODE	SPEC	MATERIAL
RAVENNA	PL-RH-MCS-40	400	Full Carbon
	PL-RH-MCS-42	420	Full Carbon
	PL-RH-MCS-44	440	Full Carbon

Super Light Carbon Racing Handlebar / Dual Routing Integrated cable for Shimano and Campagnolo / Bar centre 31.8

Weight: 205 g / 42cm (V)

**SAN MARTINO - aero wing bar**

*Unique integrated twin-tunnel cable routing gets rid of the feel of cables  
Tunnel placement works with both Campagnolo and Shimano  
Unique design maximises stiffness .Perfect balance of alloy and carbon  
Unparalleled comfort and strength  
Improved performance from increased strength,  
Incredibly hi-impact resistance  
Anatomically designed for maximum fatigue relief  
Reduces stress on the wrist*



Series	PL CODE	SPEC (c to c)	MATERIAL
SAN MARTINO	PL-RH-OS-ACB-40	400	Carbon / 7075 AL
	PL-RH-OS-ACB-42	420	Carbon / 7075 AL
	PL-RH-OS-ACB-44	440	Carbon / 7075 AL

Carbon Racing Wing Shape Handlebar / Integrated Cable Routing for Shimano and Campagnolo / Carbon Half Wrapped+AL6061 / Bar Centre 31.8 mm

Weight :335 g / 420 mm (V)

**ABDUCTOR -Carbon ergonomic bar**

Carbon wrapped centre section

A true rider's bar, the 31.8mm diameter extends all the way out to the bend

This bar has been designed to reduce the stress in abductor muscles of the hand

Comfort is enhanced by the 31.8mm diameter all the way across the top and you cant feel the cables

One user comment - "whoever designed this bar must have been a rider"

**Has to be ridden to realize there is no other bar like this one**



Series	PL CODE	SPEC (c to c)	MATERIAL
ABDUCTOR - Carbon -	PL-RH-AB-AC-40	400	Carbon / 6061 AL
	PL-RH-AB-AC-42	420	Carbon / 6061 AL
	PL-RH-AB-AC-44	440	Carbon / 6061 AL

Carbon handlebar, Abductor Hand support system bar, cable routing for Shimano and Campagnolo, centre section by carbon wrapped +AL6061, bar centre 31.8 mm

Weight: 302g / 42cm (V)

**ABDUCTOR - Alloy 7075 ergonomic bar**

Abductor 7075 ergonomic bar

7075 series aluminium

Superlight with 6 tapers along it's length - triple butted

31.8mm diameter all the way across the top of the bar

Designed for the rider who needs maximum comfort

Series	PL CODE	SPEC (c to c)	MATERIAL
ABDUCTOR - AL 7075 -	PL-RH-AB-A7-40	400	Alloy 7075
	PL-RH-AB-A7-42	420	Alloy 7075
	PL-RH-AB-A7-44	440	Alloy 7075

AL 7075 Racing handlebar, Abductor Hand support system bar, cable routing for Shimano and Campagnolo, Bar centre 31.8 mm, Shot peening and Black Anodized

Weight :266g / 420 mm (V)

Abductor 6061 ergonomic bar

6061 series aluminium

The same technical features as the 7075 bar

Series	PL CODE	SPEC (c to c)	MATERIAL
ABDUCTOR - AL 6061 -	PL-RH-AB-A6-40	400	Alloy 6061
	PL-RH-AB-A6-42	420	Alloy 6061
	PL-RH-AB-A6-44	440	Alloy 6061

AL 6061 Racing handlebar, Abductor Hand support system bar, cable routing for Shimano and Campagnolo, Bar centre 31.8 mm, Shot peening and Black Anodized

Weight :288 g / 420 mm (V)

**ROSETTA alloy "wing" bar**

Fashionable and comfortable wing shaped bar in alloy  
Grooved to accept cables - grooving suits both Shimano and Campagnolo  
Oversized central section to enhance rigidity

Series	PL CODE	SPEC (c to c)	MATERIAL
ROSETTA 7075	PL-RH-OS-E7-40	400	AL 7075
	PL-RH-OS-E7-42	420	AL 7075
	PL-RH-OS-E7-44	440	AL 7075

AL 7075 Racing handlebar, Triple Butted Ergo bar, cable routing for Shimano and Campagnolo, Bar centre 31.8 mm, Shot peening and Black Anodized

Weight 7075 version: 260g / 42cm (V)

Series	PL CODE	SPEC (c to c)	MATERIAL
ROSETTA 6061	PL-RH-OS-E6-40	400	AL 6061
	PL-RH-OS-E6-42	420	AL 6061
	PL-RH-OS-E6-44	440	AL 6061

AL 6061 Racing handlebar, Triple Butted Ergo bar, cable routing for Shimano and Campagnolo, Bar centre 31.8 mm, Shot peening and Black Anodized

Weight 6061 version: 280g / 42cm (V)

**CHIVETTA - Alloy Bar**

Series	PL CODE	SPEC	MATERIAL
CHIVETTA 7075	PL-RH-OS-A7-40	400	AL 7075
	PL-RH-OS-A7-42	420	AL 7075
	PL-RH-OS-A7-44	440	AL 7075

AL 7075 Racing handlebar, Triple Butted taper bar, cable routing for Shimano and Campagnolo, Bar centre 31.8 mm, Shot peening and Black

Weight :266g g / 420 mm (V)

Series	PL CODE	SPEC	MATERIAL
CHIVETTA 6061	PL-RH-OS-A6-36	360	AL 6061 (P.G)
	PL-RH-OS-A6-38	380	AL 6061 (P.G)
	PL-RH-OS-A6-40	400	AL 6061
	PL-RH-OS-A6-42	420	AL 6061
	PL-RH-OS-A6-44	440	AL 6061

AL 6061 Racing handlebar, Triple Butted taper bar, cable routing for Shimano and Campagnolo, Bar centre 31.8 mm, Shot peening and Black Anodized

Weight :288 g / 420 mm (V)

**SANTA MARINA- TRACK HANDLEBAR**

This is another great addition the Pro-Lite range. It's light and very strong  
Best of all this bar is designed for the track by track riders  
Using Pro-Lite tubing we developed the San Marina bar.  
Made from 6061 triple butted alloy.

Series	PL CODE	SPEC (c to c)	MATERIAL
SANTA MARINA	PL-KH-A6-40	400	Alloy 6061
	PL-KH-A6-42	420	Alloy 6061
	PL-KH-A6-44	440	Alloy 6061

AL 6061 Track handlebar, Triple Butted, bar centre 31.8 mm, Shot peening and Black Anodized

Weight: 392g / 42cm (V)



**CERVIA - Aero bar**

*Developing a full carbon aero bar was something that came easy to our design team*

*With the experience we have in designing new and exciting products for many other famous brands around the world .*

*We simply looked more closely at what riders were telling us they wanted*

*Not only incredibly light, its offers amazing stiffness and performance so the rider can really focus on giving 100% effort into the ride.*

*The micro adjusters allow the rider to be exactly where they want to be without having to waste time with allen key and spanners to get the right set up*

*Extremely aerodynamic using Leading Edge Deflection Technology LEDF*



**Time Trial Straight extension bar**  
PL-AR-MC-42T



**Triathlon style arched extension bar**  
PL-AR-MC-42H

Series	PL CODE	Extension Bar
Cervia	PL-AR-MC-42H	Triathlon arched extension bar
	PL-AR-MC-42T	Time Trial Straight extension bar,

Aero Bar set , Full Carbon Monocoque type, bar centre 31.8 mm, Internal brake cable routing . Optional for Triathlon ( arched bar ) and Time Trial ( Straight bar ) extension bar .

Weight 730g (V)

**SALEMO - Clip-on type**

Constructed to allow maximum adjustment yet retains all the features of Leading Edge Deflection Technology. The clamps are also removable for track use without arm support.



**Triathlon style arched extension bar**  
PL-AR-MP-42H



**Time Trial Straight extension bar**  
PL-AR-MP-42T

Adjustable to all riders positions  
Internal cable routing  
Easy to adjust in seconds  
clamp on extensions

Series	PL CODE	Extension Bar
Cervia	PL-AR-MP-42H	Triathlon arched extension bar
	PL-AR-MP-42T	Time Trial Straight extension bar,

Aero Bar set , Full Carbon Monocoque type, bar centre 31.8 mm, Internal brake cable routing . Optional for Triathlon ( arched bar ) and Time Trial ( Straight bar ) extension bar .

Weight 730g (V)

## EPO



**Triathlon style arched extension bar**  
PL-TH-EPO-ALH



**Time trial style straight extension bar**  
PL-TH-EPO-ALT

Comes with parts to fit 25.4 and 31.8 diameter bars  
Arm rest and pads included

	PL CODE	Extension bar	SPEC
EPO	PL-TH-EPO-ALH	Triathlon arched extension bar	
	PL-TH-EPO-ALT	Time Trial Straight extension bar,	

Clamp on type Tri bar , full adjustable, with arm rest and pad, with shim, for both bar centre 31.8 mm and 26.0, time trial style straight extension bar .  
Optional for Triathlon ( arched bar ) and Time Trial ( Straight bar ) extension bar .

Weight :470 g (V)

## LIVENZA - BULL HORN HANDELBAR ONLY



**Sold separately to EPO tri bar also**  
BULL HORN HANDELBAR ONLY

BULL HORN HANDELBAR ONLY			
Series	PL CODE	SPEC	MATERIAL
LIVENZA	PL-TH-A6-40	400	Alloy 6061
	PL-TH-A6-42	420	Alloy 6061
	PL-TH-A6-44	440	Alloy 6061

AL6061 Aero bar, Triple Butted Bull Horn bar , bar centre 31.8 mm, Shot peening and Black Anodized

Weight :234 g / 420 mm (V)

## RISCONE

## ◆ Handlebar Tape



Shock absorbent

Durable Comfortable feel

The handlebar is the one place where you get to feel everything you ride over, which is why our carbon and dynatecnic tapes offer such amazing comfort. Shock absorbing material and a high amount of know how, provides a luxurious feel and isolates you from fatiguing high-frequency vibration. Tested in some of the toughest races in the world with the toughest riders around, Pro-Lite allows you to experience a new level of comfort and control.

Series	PL CODE	SPEC	MATERIAL
RISCONE	PL-HT-CB-B	<b>Black Carbon</b>	CORK / GEL
	PL-HT-CB-W	<b>Silver Carbon</b>	CORK / GEL

Cork Handlebar tape , EMBOSSED CORK GEL RIBBON Black (optional :silver) Finish, W/ADHESIVE and 20 mm tailpiece / Carbon looking plug

Series	PL CODE	SPEC	MATERIAL
RISCONE	PL-HT-BK	Black	CORK / GEL

Cork Handlebar tape , EMBOSSED CORK GEL RIBBON Black Carbon finish, W/ADHESIVE and 20 mm tailpiece / Black Carbon looking plug

## ◆ Stem

**ELBRUS - Carbon Stem**

Professional quality at an aggressive price  
 Forged, CNC and Composite construction  
 Professional quality at an aggressive price  
 Can be used for Road, Cyclo-cross or MTB



Series	PL CODE	SPEC	MATERIAL
ELBRUS	PL-RS-OS-ACB-90	90	Carbon ALLOY
	PL-RS-OS-ACB-100	100	
	PL-RS-OS-ACB-110	110	
	PL-RS-OS-ACB-120	120	
	PL-RS-OS-ACB-130	130	

Carbon wrapped stem , Full 3K carbon wrapping +AL6061 / angle  $\pm 10^\circ$  / 31.8 Bore / Flip Flop-/ PRO-LITE decal

Weight : 155 g / EXT 100 (V)

**PELMO - CNC Stem**

Machined from a single billet of 6061 aerospace alloy  
 Pro rider product, for use on road, cyclo-cross or MTB.

Series	PL CODE	SPEC	MATERIAL
PELMO	PL-RS-NC6-90	90 / 25.8	AL 6061 CNC
	PL-RS-NC6-100	100 / 25.8	
	PL-RS-NC6-110	110 / 25.8	
	PL-RS-NC6-120	120 / 25.8	
	PL-RS-NC6-130	130 / 25.8	

Alloy CNC Stem, angle  $\pm 6D$  / 25.8 bore ( work for 25.4 MTB and 26.0 Racing bar , Shot peening and Black Anodized / Pro Lite flip flop laser logo

Weight : 116 g / EXT 100 (V)

Series	PL CODE	SPEC	MATERIAL
PELMO	PL-RS-OS-NC6-90	90 / 31.8	AL 6061 CNC
	PL-RS-OS-NC6-100	100 / 31.8	
	PL-RS-OS-NC6-110	110 / 31.8	
	PL-RS-OS-NC6-120	120 / 31.8	
	PL-RS-OS-NC6-130	130 / 31.8	

Alloy CNC Stem, angle  $\pm 6^\circ$  / 31.8 bore/ Shot peening and Black Anodized / Pro Lite flip flop laser logo

Weight : 138 g / EXT 100 (V)

**PEDROSA - 3D Forged Stem**

4 bolt clamping for increased load spread at the clamp  
 Options +/-10 deg, 25.8mm bore and +/-10 deg, 31.8mm

Our entry level racing stem, aimed at club level bikes, this stem still offers features usually associated with considerably higher priced models.

One piece forged to maximise strength and rigidity, incorporating the Pro-Lite standard OSB (opposing steerer bolt) system to allow for uniform stem to steerer clamping. 4 bolt open front for rapid assembly/disassembly and maximum contact surface area.

Perfect for all uses on and off road

Series	PL CODE	SPEC	MATERIAL
PEDROSA	PL-RS-OS-D1-60	60 / 31.8	3D forged AL 6061
	PL-RS-OS-D1-70	70 / 31.8	
	PL-RS-OS-D1-80	80 / 31.8	
	PL-RS-OS-D1-90	90 / 31.8	
	PL-RS-OS-D1-100	100 / 31.8	
	PL-RS-OS-D1-110	110 / 31.8	
	PL-RS-OS-D1-120	120 / 31.8	

Alloy 3D Forged Stem, angle  $\pm 10^\circ$  / 31.8 bore/ Shot peening and Black Anodized / Pro Lite flip flop laser logo

Weight : 148 g / EXT 100 (V)

## ◆ Frame

**GALILEO - Full Carbon Frame**

Full Carbon with polish CNC Pro-Lite Dropout

Hand crafted

CNC Integrated Head tube design

USED BY MANY PRO RIDERS AND RACE TEAMS ACROSS THE WORLD

CNC STAINLESS STEEL Replaceable Derailleur Hanger

100% HAND MADE

Frame Size ( MM )	540(L)	560(XL)	580(XXL)
Top Tube ( c to c )	550	560	575
Seat Tube ( c to c )	540	560	580
Head Tube	138	157	177
Head Tube angle	73°	73°	73°
Seat Tube angle	73.5°	73°	73°
Bottom Bracket Drop	65	65	65
Chain stay	405	408	408
Wheelbase	981.7	990	1005
Fork Rake	45	45	45
Seat Post Diameter	27.2	27.2	27.2



Series	PL CODE	Size
<b>GALILEO</b>	PBS-FCB-S	500
	PBS-FCB-M	520
	PBS-FCB-L	540
	PBS-FCB-XL	560
	PBS-FCB-XXL	580
<b>MATERIAL</b>	<b>Full Carbon</b>	

Full Carbon racing frame, for Campagnolo headset (ID 41.8), with polish CNC Pro Lite dropout, offset seat clamp, Gloss black - PRO-LITE decal

Weight : 1210 g / 50 cm (V)

Weight : 1235 g / 52 cm (V)

Weight : 1300 g / 54 cm (V)

Weight : 1310 g / 56 cm (V)

Weight : 1340 g / 58 cm (V)

**2 tone custom painting**

Series	PL CODE	Size
<b>GALILEO</b>	PBS-FCB-S.WB	500
	PBS-FCB-M.WB	520
	PBS-FCB-L.WB	540
	PBS-FCB-XL.WB	560
	PBS-FCB-XXL.WB	580
<b>MATERIAL</b>	<b>Full Carbon</b>	

Full Carbon racing frame, for Campagnolo headset (ID 41.8), with polish CNC Pro Lite dropout, offset seat clamp, Gloss black & white - 2 tone custom painting - PRO-LITE decal



**BELLA Plus - 7046 / Carbon Rear Stay**

100% Hand built using exclusive Pro-Lite 7046 PBS Alloy tubing, full carbon rear triangle



7046 Alloy main frame  
Full P.B.S. carbon rear triangle  
CNC machines stainless steel drop out



Frame Size ( MM )	525(M)	545(L)	565(XL)	585(XXL)	605(3XL)
Top Tube ( c to c )	535	550	560	575	590
Seat Tube ( c to c )	525	545	565	585	605
Head Tube	120	140	160	178	200
Head Tube angle	73°	73°	73°	73°	73°
Seat Tube angle	74°	73.5°	73.5°	73°	73°
Bottom Bracket Drop	67	67	67	67	67
Chain stay	400	405	405	407	407
Wheelbase	965	980.6	990.8	1002.8	1002.8
Fork Rake	45	45	45	45	45
Seat Post Diameter	31.6	31.6	31.6	31.6	31.6



Series	PL CODE	Size
<b>BELLA PLUS</b>	PBS-RCB-XS	485
	PBS-RCB-S	505
	PBS-RCB-M	525
	PBS-RCB-L	545
	PBS-RCB-XL	565
	PBS-RCB-XXL	585
	PBS-RCB-3XL	605
<b>MATERIAL</b>	<b>AL 7046 / Carbon Rear Stay</b>	

AL7046 racing frame with PBS rear stay, for Campagnolo headset (ID 41.8), with polish CNC Pro Lite dropout, Matt black - PRO-LITE decal

Weight : 1076 g / 48.5 cm (V)  
Weight : 1198 g / 50.5 cm (V)  
Weight : 1250 g / 52.5 cm (V)  
Weight : 1278 g / 54.5 cm (V)

**2 tone custom painting**

Series	PL CODE	Size
<b>BELLA PLUS</b>	PBS-RCB-XS-WB	485
	PBS-RCB-S -WB	505
	PBS-RCB-M -WB	525
	PBS-RCB-L -WB	545
	PBS-RCB-XL -WB	565
	PBS-RCB-XXL -WB	585
	PBS-RCB-3XL -WB	605
<b>MATERIAL</b>	<b>AL 7046 / Carbon Rear Stay</b>	

AL7046 racing frame with PBS rear stay, for Campagnolo headset (ID 41.8), with polish CNC Pro Lite dropout, Gloss black & white - 2 tone custom painting - PRO-LITE decal

**BELLA- 7046 / Carbon Seat Stay**

100% Hand built using exclusive Pro-Lite 7046 PBS tubing .  
 PBS Carbon seat stays  
 CNC machined stainless steel drop out

The Pro-Lite range of alloy road frames combine Pro-Lite PBS 7046 alloy with Pro-Lite's proven Carbon Fibre technologies.



Frame Size ( MM )	525(M)	545(L)	565(XL)	585(XXL)	605(3XL)
Top Tube ( c to c )	535	550	560	575	590
Seat Tube (c to c)	525	545	565	585	605
Head Tube	120	140	160	178	200
Head Tube angle	73°	73°	73°	73°	73°
Seat Tube angle	74°	73.5°	73.5°	73°	73°
Bottom Bracket Drop	67	67	67	67	67
Chain stay	400	405	405	407	407
Wheelbase	965	980.6	990.8	1002.8	1002.8
Fork Rake	45	45	45	45	45
Seat Post Diameter	31.6	31.6	31.6	31.6	31.6

Series	PL CODE	Size
BELLA	PBS-SCB-XS	485
	PBS-SCB-S	505
	PBS-SCB-M	525
	PBS-SCB-L	545
	PBS-SCB-XL	565
	PBS-SCB-XXL	585
	PBS-SCB-3XL	605
<b>MATERIAL</b>	<b>AL 7046 / Carbon Seat Stay</b>	

AL7046 racing frame with PBS carbon seat stay, for Campagnolo headset ( ID 41.8), with polish CNC Pro Lite dropout, Matt black - PRO-LITE decal

Weight : 1170 g / 52.5 cm (V)

**2 tone custom painting**

Series	PL CODE	Size
BELLA	PBS-SCB-XS-WB	485
	PBS-SCB-S-WB	505
	PBS-SCB-M-WB	525
	PBS-SCB-L-WB	545
	PBS-SCB-XL-WB	565
	PBS-SCB-XXL-WB	585
	PBS-SCB-3XL-WB	605
<b>MATERIAL</b>	<b>AL 7046 / Carbon Seat Stay</b>	

AL7046 racing frame with PBS carbon seat stay, for Campagnolo headset ( ID 41.8), with polish CNC Pro Lite dropout, Gloss black & white - 2 tone custom painting - PRO-LITE decal

**CUNEO- Full 7046 alloy****COMAPRES TO SCANDIUM AT A FRACTION OF THE PRICE**

100% hand built Racing frame with Full PBS 7046 Pro-Lite alloy tubing  
CNC machined stainless steel drop out  
INCREDIBLE PERFORMANCE AND HANDLING



Frame Size ( MM )	525(M)	545(L)	565(XL)	585(XXL)	605(3XL)
Top Tube ( c to c )	535	550	560	575	590
Seat Tube ( c to c )	525	545	565	585	605
Head Tube	120	140	160	178	200
Head Tube angle	73°	73°	73°	73°	73°
Seat Tube angle	74°	73.5°	73.5°	73°	73°
Bottom Bracket Drop	67	67	67	67	67
Chain stay	400	405	405	407	407
Wheelbase	965	980.6	990.8	1002.8	1002.8
Fork Rake	45	45	45	45	45
Seat Post Diameter	31.6	31.6	31.6	31.6	31.6

Series	PL CODE	Size
Cuneo	PBS-FCB-XS	485
	PBS-FCB-S	505
	PBS-FCB-M	525
	PBS-FCB-L	545
	PBS-FCB-XL	565
	PBS-FCB-XXL	585
	PBS-FCB-3XL	605
<b>MATERIAL</b>	<b>Full PRO-LITE 7046 ALLOY</b>	
AL7046 racing frame with AL7046 rear stay, for Campagnolo headset (ID 41.8), polish CNC Pro Lite dropout, Matt black - PRO-LITE decal		

Weight : 1120 g / 50.5 cm (V)

Weight : 1258 g / 54.5 cm (V)

**2 tone custom painting**

Series	PL CODE	Size
Cuneo	PBS-FCB-XS.WB	485
	PBS-FCB-S.WB	505
	PBS-FCB-M.WB	525
	PBS-FCB-L.WB	545
	PBS-FCB-XL.WB	565
	PBS-FCB-XXL.WB	585
	PBS-FCB-3XL.WB	605
<b>MATERIAL</b>	<b>Full PRO-LITE 7046 ALLOY</b>	
AL7046 racing frame with AL7046 rear stay, for Campagnolo headset (ID 41.8), polish CNC Pro Lite dropout, Gloss black & white - 2 tone custom painting - PRO-LITE decal		

**PIEMONTE- Cyclocross Frame**

100% HAND BUILT USING PRO-LITES 7046 PBS TUBING  
WITH CARBON SEAT STAYS AND CHAIN STAYS  
SPECIFIC DRAWN TUBING  
AS USED BY MEMBERS OF THE GB CYCLO CROSS SQUAD  
CNC MACHINED STAINLESS STEEL DROP OUT

Frame Size ( MM )	580(M)	600(L)	620(XL)	640(XL)
Top Tube ( c to c )	550	560	570	590
Seat Tube ( c to c )	580	600	620	640
Head Tube	145	160	175	195
Head Tube angle	71°	72°	72.5°	73°
Seat Tube angle	74°	73.5°	73°	73°
Bottom Bracket Drop	60	60	60	60
Chain stay	430	430	430	430
Wheelbase	1037.9	1034.3	1034.6	1049.7
Fork Rake	50	50	50	50
Seat Post Diameter	31.6	31.6	31.6	31.6



Series	PL CODE	Size
Piemonte	FR-CC-RCB-XS	540
	FR-CC-RCB-S	560
	FR-CC-RCB-M	580
	FR-CC-RCB-L	600
	FR-CC-RCB-XL	620
	FR-CC-RCB-XXL	640
<b>MATERIAL</b>	<b>AL 7046 with PBS Carbon Rear</b>	

AL7046 Cycle Cross frame with PBS carbon rear stay ,  
for Campagnolo headset ( ID 41.8), cantilever brake  
system, with polish CNC Pro Lite dropout, Matt black -  
PRO-LITE decal

Weight : 1582 g / 60.0 cm (V)

**2 tone custom painting**

Series	PL CODE	Size
Piemonte	FR-CC-RCB-XS-WB	540
	FR-CC-RCB-S-WB	560
	FR-CC-RCB-M-WB	580
	FR-CC-RCB-L-WB	600
	FR-CC-RCB-XL-WB	620
	FR-CC-RCB-XXL-WB	640
<b>MATERIAL</b>	<b>AL 7046 with PBS Carbon Rear stays</b>	

AL7046 Cycle Cross frame with PBS carbon rear stay ,  
for Campagnolo headset ( ID 41.8), cantilever brake  
system, with polish CNC Pro Lite dropout, Gloss black &  
white - 2 tone custom painting - PRO-LITE decal

**TRENTINO- Track Frame**

EVERY TRACK RIDERS DREAM FRAME  
 UNIQUELY CNC MACHINED SEAT TUBE  
 AVAILABE WITH OR WITHOUT AERO HEAD TUBE  
 PERFECT FOR ALL TRACK USAGE, SPRINT, MADISON, PURSUIT  
 100 % HAND BUILT USING PRO-LITE TUBING  
 7005 TRIPLE BUTTED Pro Lite alloy tube  
 CNC SEAT CLAMP & LOCKING SYSTEM  
 CNC MACHINED STAINLESS DROP OUTS



PRECISION CNC MACHINED DROP OUTS

Frame Size ( MM )	580(M)	600(L)	620(XL)	640(XL)
Top Tube ( c to c )	550	560	570	590
Seat Tube ( c to c )	580	600	620	640
Head Tube	145	160	175	195
Head Tube angle	71°	72°	72.5°	73°
Seat Tube angle	74°	73.5°	73°	73°
Bottom Bracket Drop	60	60	60	60
Chain stay	430	430	430	430
Wheelbase	1037.9	1034.3	1034.6	1049.7
Fork Rake	50	50	50	50
Seat Post Diameter	31.6	31.6	31.6	31.6



Series	PL CODE	Size
Trentino	FR-TK-FAL-47	470
	FR-TK-FAL-49	490
	FR-TK-FAL-52	520
	FR-TK-FAL-54	540
	FR-TK-FAL-56	560
	FR-TK-FAL-58	580
<b>MATERIAL</b>	<b>P.B.S 7005 Triple Butted Alloy</b>	

Alloy Track frame, for Campagnolo headset ID 41.8.  
 Jumbo CNC curve seat tube with CNC aero seat clamp,  
 Pro Lite Stainless replaceable dropout, Matt black -  
 PRO-LITE decal

Weight : 1838 g / 52.0 cm (V)

**2 tone custom painting**

Series	PL CODE	Size
Trentino	FR-TK-FAL-47-WB	470
	FR-TK-FAL-49-WB	490
	FR-TK-FAL-52-WB	520
	FR-TK-FAL-54-WB	540
	FR-TK-FAL-56-WB	560
	FR-TK-FAL-58-WB	580
<b>MATERIAL</b>	<b>P.B.S 7005 Triple Butted Alloy</b>	

Alloy Track frame, for Campagnolo headset ID 41.8.  
 Jumbo CNC curve seat tube with CNC aero seat clamp,  
 Pro Lite Stainless replaceable dropout.  
 Gloss black & white - 2 tone custom painting - PRO-LITE  
 decal

## ESPRESSO- Time Trial frame



ULTRA FAST COMPACT TIME TRIAL FRAME.  
 UNIQUELY CNC MACHINED SEAT TUBE  
 CNC SEAT CLAMP AND LOCKING SYSTEM  
 DESIGNED USING LEADING EDGE DEFLECTION TECHNOLOGY  
 CNC STAINLESS STEEL MACHINED DROP OUTS  
 100% HAND BUILT



Frame Size ( MM )	530(L)	550(XL)	570(XXL)	590(3XL)
Top Tube ( c to c )	523.10	540.00	560.00	570.00
Seat Tube ( c to c )	530	550	570	590
Head Tube	125	132	134	149
Head Tube angle	72.5	72.5	73	73
Seat Tube angle	76	76	76	76
Bottom Bracket Drop	68	68	68	68
Chain stay	398	398	398	398
Wheelbase	967.4	967.4	1000.7	1011.8
Fork Rake	40	40	40	40
Seat Post Diameter	27.2	27.2	27.2	27.2

Series	PL CODE	Size
Espresso	FR-TT-FAL-48	480
	FR-TT-FAL-51	510
	FR-TT-FAL-53	530
	FR-TT-FAL-55	550
	FR-TT-FAL-57	570
FR-TT-FAL-59	590	

**MATERIAL P.B.S 7005 Triple Butted Alloy**

Alloy time-trial frame ,for Campagnolo headset ID 41.8,  
 Airlight curve seat tube with forged aero seat clamp.  
 Internal cable routing with cover. Pro Lite CNC dropout  
 ,matt black / PRO-LITE decal

**2 tone custom painting**

Series	PL CODE	Size
Espresso	FR-TT-FAL-48-WB	480
	FR-TT-FAL-51-WB	510
	FR-TT-FAL-53-WB	530
	FR-TT-FAL-55-WB	550
	FR-TT-FAL-57-WB	570
FR-TT-FAL-59-WB	590	

**MATERIAL P.B.S 7005 Triple Butted Alloy**

Alloy time-trial frame ,for Campagnolo headset ID 41.8,  
 Airlight curve seat tube with forged aero seat clamp.  
 Internal cable routing with cover. Pro Lite CNC dropout  
 ,Gloss black & white - 2 tone custom painting - PRO-LITE decal

Weight : 1640 g / 51.0 cm (V)

**Modena - Full Carbon Time Trial**

After several stages of development, we are ready to publicly announce the Pro-Lite Modena Full Carbon Time Trial Frame. This frame is under Wind Tunnel testing for further modification until August. The official products will be available at the end of October 2008.

Frame Size ( MM )	515(S)	525(M)	550(L)
Top Tube ( c to c )	<b>515</b>	<b>525</b>	<b>550</b>
Seat Tube (c to c )			
Head Tube			
Head Tube angle			
Seat Tube angle	76°	76°	76°
Bottom Bracket Drop	65	65	65
Chain stay			
Wheelbase			
Fork Rake	43	43	43
Seat Post Diameter	INTERGRATED Type ( Included )		

**2 tone custom painting**

Series	PL CODE	SPEC	MATERIAL
<b>Modena</b>	FR-TT-FCB-S-WB		Full Carbon
	FR-TT-FCB-M-WB		
	FR-TT-FCB-L-WB		

Full Carbon time-trial frame , for Campagnolo headset ID 41.8), Airlight curve seat tube with forged CNC directly type saddle clamp. Internal cable routing. Pro Lite CNC dropout ,Gloss black & white - 2 tone custom painting / PRO-LITE decal

Weight:

**Aosta - Full 7046 alloy MTB**



MTB frame-Full PBS 7046 Pro-Lite tubing  
 INCREDIBLE PERFORMANCE FROM PRO-LITE'S OWN PBS TUBING  
 100% HAND BUILT  
 COMAPRES TO SCANDIUM AT A FRACTION OF THE PRICE

**PBS Frame Tubing - For Racing Frame**



Pro-Lite have now concluded a long series of tests on a whole new range of frame tubing's in alloy and carbon fibre composites. These exhaustive tests, which have been ongoing for many months, have had the objective of allowing the design and creation of tubing sets that, in common with all the Pro-Lite product range, bring professional-quality products to the market at a price that most can afford.



Frame Size ( MM )	16.5 " (S)	18.5 " (M)	19.5 " (L)
Top Tube ( c to c )	560	575	590
Seat Tube ( c to c )	419	457	495
Head Tube	110	125	140
Head Tube angle	71°	71°	71°
Seat Tube angle	73°	73°	73°
Bottom Bracket Drop	32	32	32
Chain stay	424	400	400
Wheelbase	1052.7	1068.3	1082.8
Fork Rake	38	38	38
Seat Post Diameter	31.6	31.6	31.6



Series	PL CODE	Size
Aosta	PBS-MTN-FAL-165	16.5 "
	PBS-MTN-FAL-185	18.5 "
	PBS-MTN-FAL-195	19.5 "
<b>MATERIAL</b>	<b>Full P.B.S AL 7046</b>	

AL7046 MTB frame , For Semi Intergraded headset OD 50. polish CNC Pro lite dropout, For both V brake and Disc Brake system . Matt black - PRO-LITE decal

Weight : 1360 g / 16.5 inch (V)

**2 tone custom painting**

Series	PL CODE	Size
Aosta	PBS-MTN-FAL-165-WB	16.5 "
	PBS-MTN-FAL-185-WB	18.5 "
	PBS-MTN-FAL-195-WB	19.5 "
<b>MATERIAL</b>	<b>Full P.B.S AL 7046</b>	

AL7046 MTB frame , For Semi Intergraded headset OD 50. polish CNC Pro lite dropout, For both V brake and Disc Brake system . Gloss black & white - 2 tone custom painting - PRO-LITE decal

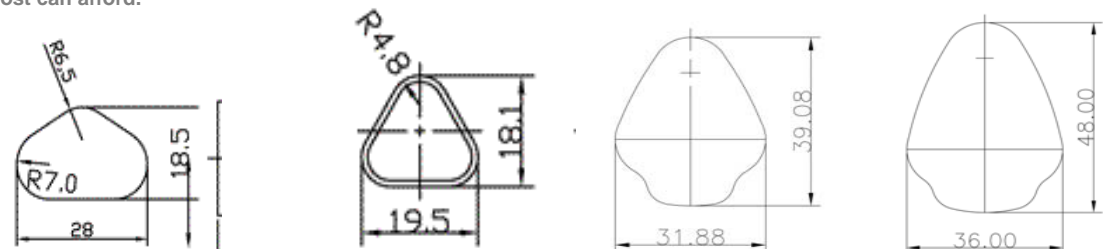



## ◆ Fork

## GRANDE- Full Carbon Fork



High modulus composite material 1 piece design  
For integrated headset designs  
2 year crash replacement warranty  
Race Proven and tested.

Series	PL CODE	Material	Steerer
GRANDE	PL-FK-MC	Full Carbon	Carbon

Carbon racing fork , full carbon monocoque, 1.1/8"

Weight :382 g / 300 L / Carbon Steerer (V)

## GIRALBA- composite road fork



High modulus carbon fork blades  
Designed for integrated headsets  
Cold Forged alloy dropouts  
2 year crash replacement warranty  
Available with alloy or carbon steerer

Series	PL CODE	Material	Steerer
GIRALBA	PL-FK-CB-A	Carbon	Alloy
	PL-FK-CB-C	Carbon	Carbon

Carbon Racing fork, AL crown and dropout, for integrated 1.1/8" headset

Weight :498g / 300 L / Carbon Steerer (V)

Weight :520 g / 300 L / Alloy Steerer (V)

**GIAVANNI- composite fork for Time Trial & Track**

High modulus carbon fork blades  
 Designed for integrated headsets  
 Cold Forged alloy dropouts  
 2 year crash replacement warranty Race Proven  
 Available with carbon or alloy steerer

Series	PL CODE	Material	Steerer
GIAVANNI	PL-FK-CB-EA	Carbon	Alloy
	PL-FK-CB-EC	Carbon	Carbon

Carbon aero racing fork, AL crown and dropout, for integrated 1.1/8" headset

Weight :498 g / 300 L / Carbon Steerer (v)

Weight :574 g / 300 L / Alloy Steerer (v)

**ENNA- composite Cyclocross Fork**

High modulus carbon fork blades 1 1/8" alloy fork column  
 Designed for integrated headsets  
 Cold Forged alloy dropouts  
 2 year crash replacement warranty

Series	PL CODE	Material	Steerer
Enna	PL-FK-CC-CA	Carbon	Alloy
	PL-FK-CC-CC	Carbon	Carbon

Pro-Lite Carbon cyclocross fork. , with Pivot

Weight :690 g / 300 L / Alloy Steerer (v)

## ◆ Headset

### AMPEZZO- integrated headset



#### Ampezzo integrated headset

3 formats: Campagnolo, Cane Creek / FSA and "semi integrated"  
High rolling sealed angular EZO Japanese contact bearings  
super smooth running no matter how heavily tightened  
CNC machined cups offer increased durability  
Fine tolerances give precision fitting

**Fit it, ride it, forget it !**

**With star Nut for Alloy Steerer**

#### 3 formats:

##### Campagnolo

1-1/8" 45°/45° angular contact bearings (OD 41.8) / For 45 or 46mm OD head tube

##### Cane Creek / FSA

1-1/8", 36°/45° angular contact bearings (OD 41.0) / For 45 or 46mm OD head tube

##### "Semi Integrated"

1-1/8", 36°/45° angular contact bearings / For 50mm OD head tube

Series	PL CODE	Size	Purpose
Ampezzo	PL-HS-INT-CAM	41.8	Campagnolo
	PL-HS-INT-CAK	41.2	Can Creek / FSA
	PL-HS-INT-CAB	50.0	Semi-Intergraded

Integrated headset , 1-1/8", EZO angular contact bearing, 30.2 x 41.8 bearing, with/al top cap, with PRO-LITE laser logo , Campagnolo compatible

Campagnolo

Weight : 68 g (V) / star nut and cap 26 g (V)

Cane Creek / FSA

Weight : 58 g (V) / star nut and cap 26 g (V)

Semi Integrated

Weight : 80 g (V) / star nut and cap 26 g (V)

### BELLUNO- conventional 1 1/8" headset

#### Belluno conventional 1 1/8" headset

High rolling sealed angular EZO Japanese contact bearings

Super smooth running no matter how heavily tightened

CNC machined cups offer increased durability

Ultra fine tolerances provide precision fitting

**Fit it, ride it, forget it !**

Series	PL CODE	Size	Colour
BELLUNO	PL-HS-01	1-1/8"	Black

Threadless Headset / 1-1/8" / Sealed Cartridge / Hi-Roll EZO Bearing / W/AL Top Cap

Weigh: 106g / without star nut and top cap (V)

Weight: 138g / with star nut and top cap (V)



Optional :  
Wedge for Carbon Steerer forks



## ◆ Seat Post

### CARESSA- composite aero seatpost



Caressa composite aero seatpost  
Aerodynamic seatpost in Carbon Fibre  
Two bolt clamp for greater stability and perfect alignment  
Available in 250 lengths 27.2mm  
Seatpost Weight 208g

Series	PL CODE	Size (OD)	Material
CARESSA	PL-SP-MC-AE25	27.2 / 250	Full Carbon
	PL-SP-MC-AE30	27.2 / 300	Full Carbon

Aero Carbon seat post, 27.2 . Monocoque Carbon

Weight :208 g / 250 L (V)

### PELLEGRINO- monocoque seatpost

**\*\*SIMPLY THE STRONGEST MONOCOQUE SEATPOST IN THE WORLD\*\***



Pellegrino 2 monocoque seatpost New Version for 2008  
Super strong 3mm wall thickness  
Anti shear clamping bolt  
Available in 250mm & 350mm length  
27.2mm & 31.6mm

**\*\*SIMPLY THE STRONGEST MONOCOQUE SEATPOST IN THE WORLD\*\***

Series	PL CODE	Size (OD)	Material
Pellegrino	PL-SP-MC-LK	27.2	Full Carbon
	PL-SP-OS-MC-LK	31.6	Full Carbon

Laid Back Carbon seat post, Monocoque Carbon

Weight :270 g / 27.2 x 350 L (V)



**SAN VITO- carbon / alloy road seatpost****Seatpost in Carbon Fibre**

Clamp is CNC machined from a single billet of aerospace alloy  
Available in 350mm length  
27.2mm & 31.6mm

Series	PL CODE	Size (OD)	Material
SAN VITO	PL-SP-AC-B	27.2	Full Carbon
	PL-SP-OS-AC-B	31.6	Full Carbon

Carbon seat post, Alloy CNC seat rail clamp with full 3K Carbon post

Weight :226 g / 27.2 x 350 L (V)

**◆ Seat Clamp****GARDA - Offset for carbon post****Forged - CNC seatpost clamp**

Offset cut to spread load on Carbon Seat pins  
Pivoting nut to allow smooth tightening  
CNC machined from a single piece of aerospace alloy



Series	PL CODE	Size	Purpose
GARDA	PL-SC-A1K.	31.8	Alloy Frame
	PL-SC-A1K.OV	34.9	Alloy Frame
	PL-SC-A1K.H	31.8	Carbon frame

Alloy forged seat clamp ,Special design for Carbon seat post - Anti Slip system , black with Pro Lite logo

Weight: 22g / 31.8mm (V)

Weight: 24g / 34.9mm (V)

## ◆ Saddle

### SAN CARLO saddle

How can we describe something as important as a saddle without generating thousands of words? Its true a picture speaks a thousand words and the Pro-Lite saddles are summed up in one word – comfy. The pelvic bone is fully supported and cushioned, the prostrate area has the pressure greatly reduced and the ventilation is increased.

The rails are designed to not only support the saddle but allow flex and maximum strength. Designed to provide hours and hours of comfort, the only way you can experience this claim is to try one – you will not be disappointed.



**Professional Racing Saddle**  
**Patented Double Density**  
**Patented ArcTech Rail**  
**Full Zone Cut for Comfort**  
**Top Genuine Leather cover In**  
**Carbon Fibre Injected Base**  
**Titanium Rail with index**  
**Super Light Foam**



Series
San Carlo
Racing Saddle - D2 Carbon Fibre Base / 100% Genuine Leather cover In White Black Carbon Wing, Ti.Rail / Super Light Foam / PRO-LITE Logo on Nose / San Carlo on Back Side , Black Bumper Front and Rear

Weight :209 g (V)

### NANTO saddle

Series
Nanto
Racing Saddle - 100% genuine leather cover , Chromo Satin Rail With Index , Super Light Foam / PRO-LITE Logo on Nose / Black Bumper Front And Rear

Weight :220 g (V)



**Professional Racing Saddle**  
**K10 Leather Cover Black**  
**Patented Double Density Base Technology To**  
**Alleviate Pressure Points**  
**Patented ArcTech Rail Mounting Technology To Absorb Shock**  
**Full Zone Cut for Comfort**  
**Chromo Satin Rail with index**  
**Super Light Foam**



### CLES saddle



Series
Cles
Racing saddle , With Air Hole / Nose With Embossed Arrow Mark In Sliver / Pad Printed-" PRO-LITE logo In White Colour. "Cles logo in White Colour . Embossed Sliver Oval Base , Bottom with Embossed Oval-Shaped "PRO-LITE" Logo in Sliver , Chromo Satin Rail with Index , Super Light Foam / Black Bumper Front and Rear

Weight :258 g (V)

## ◆ Crank set

### SIENA- High Modulus Carbon Crank



Super Light Weight, Full Carbon Monocoque Crank  
Oversize Axle and outer bearing bottom bracket set  
Crank set comes complete with outer bearing bottom bracket set

### SASSARI- 7075 Alloy Crank set



Road : BCD 130 - 53 / 39 T	
PL-CK-CN-D130-70	170
PL-CK-CN-D130-72	172.5
PL-CK-CN-D130-75	175
Compact : BCD 110 - 50 / 34 T	
PL-CK-CN-D110-70	170
PL-CK-CN-D110-72	172.5
PL-CK-CN-D110-75	175

Carbon Crank set / Full Carbon Monocoque Crank / Forged Spider Alloy 7075 T6 High Polish Black With CRO-MOLY SCM435 BB Axle / With BB -BC1.37 X 24 X 68 Outside Bearing / Double Full CNC 7075 T6 Chain ring / With PRO-LITE Logo

Weight: 170mm - 578g (Right side) / 258g (Left side) (V)  
Weight: BB set - 120g (V)

The Siena is a revolutionary new design of carbon crank. Designed in close cooperation with a team of 15 riders on the European race circuit.

New production methods developed by Pro-Lite are used for these cranks, to create a huge increase in total stiffness, and the crank's stiffness-to-weight ratio sets new standards. In-house lab testing of various high-end cranks has proven the superior performance of the "Siena" crank over a number of well known brands.

The sealed bearing bottom bracket is designed to simply not flex at all and thus allows increased power transmission for the rider.

These cranks have undergone extensive road tests with heavier riders up to 95 kg in weight without any problem. Safety is always our highest priority and the "Siena" is able to continually withstand the highest loads applied by any rider.

The Sassari is based on the same technology we use for Siena and we use laser technology for the alignment of the crank to the BB spindle. Designed for the true connoisseur you will not be disappointed when you see the craftsmanship involved with this crank set.

Stiffness is the key to crank performance and the design team were simply focussed on producing maximum stiffness when we set about developing this crank. Once we came up with the initial design we went back to the drawing board and improved the stiffness further.

The bottom bracket uses EZO Angular contact Japanese bearings produced for use on aircraft and will provide a lifetime of use with very little maintenance. Once fitted you can rest at ease and get on with your cycling knowing that you have purchased a Pro-Lite product that simply provides peace of mind.

Road : BCD 130 - 53 / 39 T	
PL-CK-A7B-D130-70	170
PL-CK-A7B-D130-72	172.5
PL-CK-A7B-D130-75	175
Compact : BCD 110 - 50 / 34 T	
PL-CK-A7B-D110-70	170
PL-CK-A7B-D110-72	172.5
PL-CK-A7B-D110-75	175

Alloy Forged 7075 T6 Crank set / Forged Spider Alloy 7075 T6 / High Polished Black / With CRO-MOLY SCM435 BB Axle / With BB -BC1.37 X 24 X 68 Outside Bearing / Double Full CNC 7075 T6 Chain ring / With Laser PRO-LITE Logo

Weight: 170mm - 625g (Right side) / 258g (Left side)(V)  
Weight: BB Set - 120g(V)

**SAVONA- 6061 Alloy Crank set**

Road : BCD 130 - 53 / 39 T	
PL-CK-A6B-D130-70	170
PL-CK-A6B-D130-72	172.5
PL-CK-A6B-D130-75	175
Compact : BCD 110 - 50 / 34 T	
PL-CK-A6B-D110-70	170
PL-CK-A6B-D110-72	172.5
PL-CK-A6B-D110-75	175

Alloy Crank set / Forged 6061 T6 Alloy  
High Polished Black / With CROMOLY  
SCM435 BB Axle / With BB -BC1.37 X 24  
X 68 Outside Bearing / Double Full CNC  
7075 T6 Chain ring / With Laser PRO-LITE  
Logo

Weight: 172.5mm - 562g (Right side) / 216g (Left side)(V)  
Weight: BB set - 120g(V)

The Savona 6061 crank with our external bearing BB system has proven to be a real winner. The Savona is forged out of Aerospace AL-6061-T6 alloy material and is designed to not only look beautiful, but also to be strong and light. The addition of the external BB offers superior and durable bearing design and is lighter than conventional designed BB's. As with all Pro-Lite crank sets we provide precision machined cnc chain rings that are specifically machined to ensure ultra smooth shifting. The teeth profiles are unique and have undergone over 12 months testing both on and off road to let you enjoy riding and one less thing to worry about.

**SONDRIO- 7075 Track**

The Sondrio is Pro-lite's pure track crank. It is short, light and stiff, with mountings for only one ring. Built as a track version of the Siena we don't need to say anymore than what we do about the Siena, it does exactly what is says on the box

**SASSARI- 7075 Alloy Crank set -Time Trial**

TT : BCD 130 - 56 T	
PL-CK-A7B-D1356T-70	170
PL-CK-A7B-D1356T-72	172.5
PL-CK-A7B-D1356T-75	175

AL 7075 TIME-TRIAL Crank set / Single Speed / Forged  
7075 T6 Alloy / Forged Spider Alloy 7075 T6 High  
Polished Black / BCD 130 / With CROMOLY SCM435  
BB Axle / With BB -BC1.37 X 24 X 68 Outside Bearing /  
Full CNC 7075 T6 Chain ring 56T / With Laser PRO-  
LITE Logo

Single Chain ring , For Time Trial Bike  
7075 Alloy forged Crank oversize Axle bottom bracket set  
Variety of sizes available - contact for details  
Crank set comes complete with outer bearing bottom bracket



**Pro-Lite Power Drive System Axle 12 T / No taper ( much better and Strong than ISIS )**

**BCD 144 for Track / Available chain ring : 48 - 52 T**

Pro-Lite Power Drive System Axle ( Far superior and Stronger than ISIS system for maximum power output  
Crank set comes complete with Pro Lite Power Drive BB parts delivering the ultimate in power transfer.

Type	PL Code	Crank	Material
Track PCD 144 - 48 T	PL-CK-A7B-D4-486	165	7075
	PL-CK-A7B-D4-487	170	7075

TRACK Alloy Crank sets / 7075 Alloy Forged / Hi Polish Anodized Black Chain wheel Set / PRO-LITE  
Power Drive System - BCD 144 - Full CNC Chain ring - 48 T / With PRO-LITE Power Drive BB Set / Chain  
ring : 1/2 x 1-1/8 "

Weight: 165mm - 512g (Right side) / 268g (Left side) (V) Weight: BB Set - 262g (V)



## ◆ WHEELS

### PADOVA DISC

Use the Pro-Lite New 2-in-1 hub:

2 in 1 Hub, easy to switch for Road and Track system, this takes less than one minute to achieve.

AS USED BY TEAM GB Fire Service, GLOBAL RACING, RUITER DAKKAPellen Wielerteam & MARIO HAMMER just to name a few.



Disc - Tubular



Disc - Clincher / Alloy wall

#### Disc - Tubular

##### PL CODE

PADOVA-R00-MT-S	Shimano	Full Carbon
PADOVA-R00-MT-C	Campy	Full Carbon

Full Carbon Rear Disc Wheel , Tubular , 2 in 1 hub FOR Track and Road , Without Wheel Bag , With Pad For Valve Hole

Weight : 1295 g / Road type / without decal (V)

#### Disc - Clincher / Alloy wall

##### PL CODE

PADOVA-R00-XH-S	Shimano	Carbon / Alloy braking wall
PADOVA-R00-XH-C	Campy	wall

Full Carbon Rear Disc Wheel with alloy braking wall , Clincher , 2 in 1 hub For Track and ROAD, Without Wheel Bag , With CARBON Pad For Valve Hole



Using the same EZO bearings we use in the Bolzano hub, the wheel has a very low rolling resistance compared to standard sealed bearing wheels and 5 bearings will ensure a lifetime of outstanding performances.

**ROME- 4 Spokes Full Carbon wheelset**

The 4 spoke carbon wheel is the ultimate in monocoque carbon wheels. Producing incredible rigidity and providing the perfect responsiveness, the superb ride generated from this wheel will truly enhance any rider's performance. Created using the very latest 3D software and manufacturing techniques we have ensured the aerodynamics of this wheel cut through the air with the minimum of drag without reducing performance. Lateral rigidity is extremely high in order to maximise power output by the rider without compromising weight or aerodynamics.

Virtually maintenance free the wheel allows you to simply fit it and ride. Available for both track and road use the high modulus carbon fibre is perfect for use under both conditions and can easily be used by tandems as well.

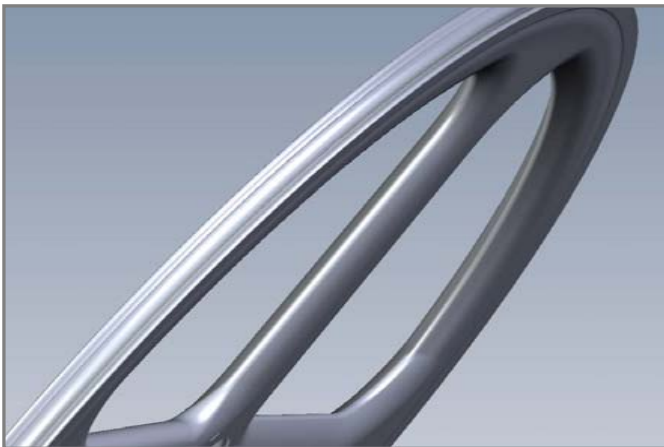

4 Spoke - Tubular		
Series	Type	PL-Code
Rome	Front	ROME-F4W-MT
	Shimano rear	ROME-R4W-MT-S
	Campy rear	ROME-R4W-MT-C

Spec.: Full Carbon 4 spoke wheelset.

Weight

Weight



**VICENZA**

**VICENZA - Carbon Tubular**



Vicenza-F50-MT



Vicenza-F90-MT



PRO-LITE 2:1 hub			
PL CODE	System	Material	Weight
Vicenza-F50-MT	Front	50	800 g (V)
Vicenza-F90-MT	Front	90	950 g (V)

Full Carbon Tubular Front Wheel / 2 in 1 Pro Lite hub / 20 Radial / Aero Spoke / Enclosed Ice Cube -Spoke Holder & Nipple Driver / With Brake Pad And Wheel Bag



Vicenza-R90-MT-S



**PRO-lite 2:1 hub**



**1 MINUTE ROAD TO TRACK**



PRO-LITE 2:1 hub			
PL CODE	System	PROFILE	Weight
Vicenza-R90-MT-S	Shimano + Track	90 mm	1084 g (V)
Vicenza-R90-MT-C	Campy + Track	90 mm	1084 g (V)

Full Carbon Rear 90 mm Tubular / 2 in 1 Pro Lite hub / 24 / 3 cross / Aero Spoke / Enclosed Ice Cube -Spoke Holder & Nipple Driver / With Brake Pad And Wheel Bag

**VICENZA - Carbon Clincher / Alloy wall**



Vicenza-F50-XH



Vicenza-F90-XH



PRO-LITE 2:1 hub			
PL CODE	System	PROFILE	Weight
Vicenza-F50-XH	Front	50	1010 g (V)
Vicenza-F90-XH	Front	90	1160 g (V)

Full Carbon Clincher Front Wheel / 2 in 1 Pro Lite hub / 20 Radial / Aero Spoke / Enclosed Ice Cube -Spoke Holder & Nipple Driver / With Brake Pad And Wheel Bag



Vicenza-R90-XH-S



**PRO-lite 2:1 hub**



**1 MINUTE ROAD TO TRACK**



PRO-LITE 2:1 hub			
PL CODE	System	PROFILE	Weight
Vicenza-R90-MH-S	Shimano	90	1342 g (V)
Vicenza-R90-MH-C	Campy		

Full Carbon Rear Wheel 90MM / Clincher With Alloy Braking Wall / 2 in 1 Pro Lite Hub / 24 - 3 Cross / Aero Spoke / Enclosed Ice Cube -Spoke Holder & Nipple Driver / With Brake Pad And Wheel Bag

**Gavia Wheelset range**



**Bolzano Hub**

**Gavia Wheelset range**

From 2008, Pro Lite has decided to expand our Gavia wheelset range. Each Gavia wheelset is equipped with our patented "Bolzano" hub.

The Pro-Lite Bolzano hub is designed to provide maximum power to output ratios, whilst offering superior wheel stability and structure. When coupled with the unique Pro-Lite spoke made from Swedish Stainless Steel, you have a combination that is everything the rider needs. During tests using several Pro riders, we used a power meter set at 300 watts of power over 50km and the results were amazing. The result was an average faster time over 50km of 89.2 seconds.

What was also consistent, were the comments riders made after each test. The phrase "those wheels feel really fast" was repeated many times. It became evident that lighter wheels flex far too much under maximum load by the rider and weight saving does have its disadvantages, that being the wheel flexes far too much causing the rider to waste far more power to maintain the same speed and therefore a Pro-Lite wheel allows the rider to maximise the power output and actually go faster using the same amount of power. In plain English the power transfer on a Pro-Lite wheel is far superior to that of other wheels on the market.

**GAVIA- Carbon Tubular**



**Gavia-P55-MT-S**



**Gavia-P99-MT-S**



**PRO-LITE PATENETED Bolzano Hub  
WHEEL TECHNOLOGY AT ITS FINEST**

Bolzano Hub	PL CODE	PROFILE	Freebody	Weight
	Gavia-P55-MT-S	Front 50 mm	Shimano	Front : 756 g (V)
Gavia-P55-MT-C	Rear 50 mm	Campagnolo	Rear : 928 g (V)	
Gavia-P59-MT-S	Front 50 mm	Shimano	Front : 756 g (V)	
Gavia-P59-MT-C	Rear 90 mm	Campagnolo	Rear : 1070 g (V)	
Gavia-P99-MT-S	Front 90 mm	Shimano	Front : 910 g (V)	
Gavia-P99-MT-C	Rear 90 mm	Campagnolo	Rear : 1070 g (V)	

Full Carbon Tubular front and rear wheel sets / Pro Lite Bolzano hub / Aero Spoke / Enclosed Ice Cube -Spoke Holder & Nipple Driver / With Brake Pad And Wheel Bag



**Gavia-P59-MT-S**

## GAVIA - Full Carbon Clincher

Gavia wheelset full carbon clincher  
 Built around our unique, patent "Bolzano" hub set  
 The only SAFE carbon clincher wheel

Pictured right is the lowered braking surface used by Pro-Lite. Also pictured below to the right is a conventional brake shoe and pad. By lowering the braking surface and using the Pro-Lite brake pad, this eliminates heat distortion and allows tyre pressures of up to 150psi without any problems.

The unique design of the braking surface will not distort under braking, unlike every other manufacturers' rims, who also impose ridiculously low maximum tyre pressure's due to the fact that their rims flex under braking.

With the introduction of a ceramic coating onto the braking surface, combined with the Pro-Lite brake pad supplied you need never worry about braking performance again. in the wet or dry. As tested by some of the most fearless and stupid riders we could find!

As a result of the points above, this is probably the safest carbon clincher on the market



Gavia-P55-MH-S



Gavia-P33-MH-S



PRO-LITE PATENETED Bolzano Hub  
 WHEEL TECHNOLOGY AT ITS FINEST

Clincher - Full Carbon		Freebody		Weight
Bolzano Hub	PL CODE	Profile		
	Gavia-P33-MH-S	Front 38 mm	Shimano	Front - 665 g (V)
	Gavia-P33-MH-C	Rear 38 mm	Campagnolo	Rear : 865 g (V)
	Gavia-P55-MH-S	Front 50 mm	Shimano	Front - 756 g (V)
	Gavia-P55-MH-C	Rear 50 mm	Campagnolo	Rear : 928 g (V)

Full Carbon Clincher Wheelset, Front and Rear / Pro Lite Bolzano Hub / Aero Spoke / With Offset Brake Shoe / Enclosed Ice Cube -Spoke Holder & Nipple Driver / With Brake Pad And Wheel Bag

**GAVIA- Carbon Clincher / Alloy Wall**



Gavia-P55-XH-S



Gavia-P59-XH-S



Gavia-P99-XH-S



**PRO-LITE PATENETED Bolzano Hub  
WHEEL TECHNOLOGY AT ITS FINEST**

	PL CODE	PROFILE	Freebody	Weight
<b>Bolzano Hub</b>	Gavia-P55-XH-S	Front 50 mm	Shimano	Front : 1002 g (V)
	Gavia-P55-XH-C	Rear 50 mm	Campagnolo	Rear : 1170 g (V)
	Gavia-P59-XH-S	Front 50 mm	Shimano	Front : 1002 g (V)
	Gavia-P59-XH-C	Rear 90 mm	Campagnolo	Rear : 1355 g (V)
	Gavia-P99-XH-S	Front 90 mm	Shimano	Front : 1186 g (V)
	Gavia-P99-XH-C	Rear 90 mm	Campagnolo	Rear : 1355 g (V)

Full Carbon Clincher wheelset Front and Rear / Alloy Braking Wall / Pro Lite Bolzano Hub / Aero Spoke / Enclosed Ice Cube -Spoke Holder & Nipple Driver / With Brake Pad And Wheel Bag

**GAVIA- Super Light Alloy wheelset**

This new rim was developed to provide the minimum in wind resistance and give maximum weight savings without compromising strength. Originally designed for the Japanese market where they race a lot up mountains due to the lack of space for road racing. Mount Fuji race is one good example. When you see the mountains they race up you will realize that they need optimal strength and minimum weight. Combined with the unique power deliver from the Bolzano hub this makes this wheel the ultimate wheel for light weight and power delivery.

**PRO-LITE PATENETED Bolzano Hub  
WHEEL TECHNOLOGY AT ITS FINEST**

Bolzano Hub	PL CODE	PROFILE	Freebody	Weight
	Gavia-P22-AH-S	Front 22 mm	Shimano	Front : 640 g (V)
Gavia-P22-AH-C	Rear 22 mm	Campagnolo	Rear : 832 g (V)	

Super Light Alloy Clincher wheelset Front and Rear / 22 mm Profile / Pro Lite Bolzano Hub / Double butted Aero Spoke / Enclosed Ice Cube -Spoke Holder & Nipple Driver

**BRACCIANO - 1480 g**

Super light Alloy 6066 material, Flash Welding.  
27 mm profile for superior aerodynamic performance.  
2 in front hub, 5 in rear hub angular contact bearing (Japanese EZO)  
Available for Campagnolo or Shimano freehub bodies  
20 Spoke Front, 24 Spoke Rear.  
PRO-LITE double butted stainless aero spoke.  
Alloy T73 nipple.  
100% built by hand.



PL CODE	System	Finish
BRACCIANO-SS	Shimano	Polish Silver
BRACCIANO-SC	Campy	Polish Silver
BRACCIANO-BS	Shimano	Shot Blast Black
BRACCIANO-BC	Campy	Shot Blast Black

Super Light Alloy Wheel set , clincher type, Welding type , 27 mm profile Triple butted Aero spoke black , / 2x5 EZO bearing hub / Front - 20 H , Radial , Rear 24 H 2cross

Weight :F - 618 g / R - 864 g (V)





## STELVIO



A superb wheel designed for a lifetime of use. Supplied to many race teams in Europe, for both racing and training.

Virtually maintenance free hubs. Great for Road/Criterium, Cyclo-cross and time trial.

Super Light Alloy KLM T10 material  
30 mm profile for maximum aerodynamic performance  
2 x 5 cartridge bearing ( Japan EZO)  
Available for Campagnolo or Shimano  
20 Spokes Front Radial  
24 Spokes Rear - 2 Cross  
PRO-LITE 3.2 mm stainless aero spoke.



PL CODE	Syster	Finish	Profile
Stelvio-S	Shimano	Polish Black Anodized	30 mm
Stelvio-C	Campy	Polish Black Anodized	30 mm

Alloy KLM41, T10 Sleeve Wheel set , clincher type, 30 mm profile polish black finish , 3.2 Aero spoke black , / 2x5 EZO bearing hub black / Front - 20 H , Radial , Rear 24 H 2cross

Weight :F- 696 g / R- 944 g / Shimano (V)  
Weight :F- 696 g / R- 958 g / Campy (V)



## LUCIANO



Alloy clincher rim - Sleeve construction  
Rear hub 4 EZO bearings front 2 Japanese cartridge bearings  
Ready to race straight form the box, great for Road/Criterium, Time trial, Training and cyclo-cross.  
Using 6061 alloy T6 material, 30 mm profile for maximum aerodynamic performance  
2 x 4 cartridge bearing (Japan EZO angular contact bearings)  
Available for Campagnolo or Shimano free hub bodies.  
20 Spoke Front , 24 Spoke Rear  
PRO-LITE 3.2 mm Swedish stainless aero spoke.



PL CODE	Syster	Finish	Profile
Luciano -S	Shimano	Black Anodized	30 mm
Luciano -C	Campy	Black Anodized	30 mm

Alloy Wheel set , clincher type, 30 mm profile black finish , 3.2 Aero spoke black , / 2 x4 EZO bearing hub black / Front - 20 H , Radial , Rear 24 H 2cross

Weight :F - 784 g / R - 980g / Shimano (V)  
Weight :F - 784 g / R - 1010 g / Campy (V)

**COMO**

No other hand built wheel can compete with the value for money the Como offers. Hand built Aero spokes and designed to withstand the rigours of daily use. Great for training and spare wheels.

A high value-for-money wheel set Alloy 6061 material, T6 30 mm profile for superior aerodynamic performance. Super high end bearings - ultra hard and highly polished for maximum life. Fully hand built (as are all Pro-Lite wheels) Available for Campagnolo or Shimano freehub body. 20 Spoke Front, 24 spoke Rear, PRO-LITE 3.2 mm stainless aero spoke.

A high value-for-money wheel set  
Using Alloy 6061 T6 material  
30 mm profile for maximum aerodynamic performance  
Super quality bearings - ultra hard and highly polished for maximum life  
Fully hand built (like all Pro-Lite wheels)  
Available for Campagnolo or Shimano  
20 Spoke Front, 24 Spoke Rear  
PRO-LITE 3.2 mm stainless aero spoke.



PL CODE	Syster	Finish	Profile
Como-S	Shimano	Black Anodized	30 mm
Como-C	Campy	Black Anodized	30 mm

Alloy wheel set , clincher type, 30 mm profile, alloy rim / clincher, black anodized, CNC ball crown, 3.2 Aero spoke, Front - 20 H , Radial , Rear 24 H 2cross

Weight : F- 906 g / R- 1192 g / Shimano (V)

Weight : F- 906 g / R- 1255 g / Campy (V)

**Track wheelset**

**Rosa**

When we decided to produce the ROSA we had one aim in mind. A true track wheel has to withstand a huge amount of fatigue and yet must remain true and responsive at all times. First of all the spokes are forged from the finest Swedish stainless and cnc machined to ensure the threads are precisely correct. The nipples are cnc machined so that when the wheel is built the angle between the spoke and nipple is minimal when the tension is applied during building. (Take a look at how many wheels you see in the market where the angle of the nipple and spoke exceeds 5 degrees).Pro-Lite tolerance is 2 degrees maximum. The hubs are cnc machined and fitted with EZO bearings to provide a much lower rolling resistance. During the Copenhagen 6 day, riders using the Pro-Lite track wheels commented on how smooth the wheels ran and how noticeable it was to feel the acceleration through them. Due to the Pro-Lite precision hand built wheels, the riders said just how much they could feel the difference.

Each wheel is carefully (as are all our wheels) hand built to extremely precise tolerances. Each spoke is tension checked six times during building and then we de-tension the wheel twice before final truing. Pictures can be seen in our gallery of our wheel building workshop.



Alloy clincher rim - Sleeve construction  
Precision built and tension checked 6 times

ROSA-C



Rosa-P55-MT



Rosa-P99-MT



PL CODE	Profile	Type
ROSA-P33-AH	30 mm	Clincher

Alloy Track wheel set , clincher type, 30 mm profile, alloy rim / clincher, black anodized, 2 x 2 bearing , 2.3 Aero spoke, 16t &15t (1/2 x 1-1/8") Sprocket .  
Front - 32 H -3 cross , Rear 36H 3 cross spoking

Weight : F- 1066 / R- 1180 g (V)

**Carbon - Tubular**

PL CODE	Profile	Weight
Rosa-P99-MT	90 mm	Front : 975 g(V)
	90 mm	Rear : 1076 g(V)
Rosa-P55-MT	50 mm	Front : 812 g(V)
	50 mm	Rear : 920 g(V)

Carbon Track wheel set ,Tubular 90 mm profile, 2 x 2 bearing , 2.3 Aero spoke, 16t &15t (1/2 x 1-1/8") Sprocket . Front - 20H -Radial , Rear 24H- 2 cross

Weight not including the sprocket

## MTB wheelset

### ALLEIN



ALLEIN.WH



ALLEIN.BK

PL CODE	Profile	Finish
ALLEIN.WH	19 mm	White Powder coating
ALLEIN.BK	19 mm	Shot Blast Black

Alloy MTB wheel set, Alloy rim / Sleeve / Eyelet / 2 x 4 Bearing, Triple butted Aero black spoke, Alloy Nipple / Front - 28 H , 3 cross spoking , Rear 32 H 3 cross spoking

weight F: 742 g / R :858 g (V)

Light weight MTB Wheelset

Alloy clincher rim - Flash Welding construction for maximum strength  
HUB - 4 bearings rear and 2 bearings front, cartridge

### ARAND



Hub - 4 bearings rear and 2 bearings front, cartridge



ARAND.BK

PL CODE	Profile	Finish
ARAND.WH	25 mm	White Powder coating
ARAND.BK	25 mm	Shot Blast Black

Alloy Wheel set , clincher type, 30 mm profile polish black finish , 3.2 Aero spoke black , / 2x5 EZO bearing hub black / Front - 20 H , Radial , Rear 24 H  
Weight :F- 842 g / R-1082 g (V)

**ARVIER**

HUB - 2 bearing rear 2 bearing front - cartridge



Alloy rim 22 mm profile

CNC side wall with Eyelet Black anodized finish

2 x 2 Bearing Hub with Disc brake adaptor

3.2 PRO-LITE Swedish Stainless steel Aero black spoke with Brass Nipple

Front - 28 H / 3cross, Rear 32 H / 3 cross

PL CODE	Finish	Profile
ARVIER	Black Anodized	22 mm

Alloy MTB wheel set , 22 mm profile, alloy rim / / CNC side wall/ Eyelet / Black anodized finish , 2 x 2 Bearing, 3.2 Aero black spoke, Brass Nipple / Front - 28 H , 3 cross spoking , Rear 32 H 3 cross / Shimano

weight F: 1010 g / R : 1274 g (V)

**AVISE**

HUB - 2 bearing rear 2 bearing front - cartridge



Alloy rim 26 mm profile

CNC machined side wall, Black anodized finish.

Ultra hard high polished loose ball bearing with disc brake adaptor

3.2 PRO-LITE Swedish Stainless steel Aero black spoke with Brass Nipple.

Front - 28 H/3 cross, Rear 32 H/3 cross.

PL CODE	Finish	Profile
AVISE	Black Anodized	26 mm

Alloy MTB wheel set ,26 mm profile, Alloy Rim / CNC side wall/ Black anodized finish , 3.2 Aero black spoke, Brass Nipple / Front - 28 H , 3 cross spoking , Rear 32 H 3 cross spoking / Shimano

weight F: 1116 g / R : 1332 g (V)

**COMPOSITE SKEWERS**

Brunico skewers  
 Titanium skewers with alloy and carbon levers  
 Suitable for all wheels  
 The Ultimate add on

Series	
Brunico	
PL CODE	Description
PL-HB-QR	Easy Lock Hub Skewer . Ti road , Mono Carbon level - F: 153 mm , R 187 mm . Pad print LOGO

Weight: 43g / Front (V)

Weight: 45g / Rear (V)

**WHEEL ACCESSORIES**

VALVE -45 MM



ICE CUBE AERO SPOEK HOLDER  
 Nipple Driver

PL CODE		Description
PL-WH-BG	BAG	Single Wheel Bag With Foam Inside
ICE CUBE	ICE CUBE	Spoke Holder For Aero Spoke
PL-DRV	Nipple Driver	NIPPLE DRIVER FOR Carbon WHEEL
PL-VALVE	VALVE -45 MM	Extension Valve For Carbon Rim



Single Wheel Bag

## ◆ Bottle Cage

### CASTEL FRANCO- "E-Type" bottle



Pro Lite cages are lighter than virtually any other ... but that weight saving has not been at the expense of durability. Unlike most other composite cages on the market, these bottle cages are not prone to snapping, even with many repeated bottle insertions and extractions, in the most difficult circumstances

High Modulus Carbon 3k  
Anti snapping gripper to prevent bottle escape  
Universal fitting  
Fully testing

Series
Castel Franco
Carbon Bottle cage, 3K finish with fitted fin for Anti-slipping . E type
Weight :22 g

Castel Franco "E-Type" bottle cage

### BASSANO- "Q-Type" bottle cage



Bassano "Q-Type" bottle cage

Series	PL CODE
Bassano	PL-BC-MC-Q
Carbon Bottle cage, 3K finish fitted with fin for Anti-slipping . Q type	

## CPP



Carbon Protection Patches  
Made from real carbon and Kevlar, not your cheap imitation stuff, and designed to do exactly what it says on the packet - protect your frame.

PL CODE	Description
PL-PD-CB	9 PCS Real CARBON Protection Pad / PRO-LITE Logo and Blister Card Package

**Rovigo Glasses**



Pro-Lite incorporates geometric styling to give unsurpassed fit factor. Each frame comes with 5 sets of lenses that allow you to freely manage light and mood conditions. Pro-Lite only uses specific materials that provide durable comfort.

Pro-Lite Sunglasses are designed with high ergonomic standards and optical clarity feature. Pro-Lite sunglasses come with a soft Microfiber cloth for cleaning

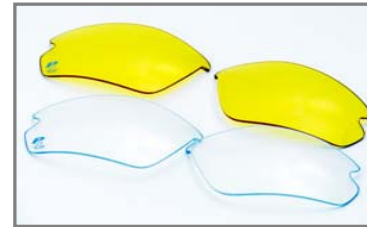

**BASEBALL CAP**



PL CODE  
PL-CP-01

**Pro-Lite BANDANNA**

Series	PL CODE	Description
PL-GS-5L		Sports Sunglass / White Frame / 5 Inter- Changeable Lenses / Frame With "PRO-LITE" Logo on Both Side / Lens with " PL" Logo on One Side / Enclosed with Soft Cloth ( with "PRO-LITE" Logo) / Hard Case with "PRO-LITE" Logo Embossed

PL CODE  
PL-BNN





**TAILORED SHIRT**

Can be worn inside for formal wear or loose for a casual look

PL CODE
PL-SR-WB-S
PL-SR-WB-M
PL-SR-WB-L
PL-SR-WB-XL
PL-SR-WB-XXL
PL-SR-WB-3XL

**Pro Lite PROMOTION BAG****POLO SHIRT**

PL CODE
PL-POLO-S
PL-POLO-M
PL-POLO-L
PL-POLO-XL
PL-POLO-XXL



PL CODE
PL-BAG

